

# Terra In-line Table

*neighbor*



## Description

Part of the Terra lounge collection, the In-line Table module can be added anywhere in your outdoor setup. Features the beauty and warmth of a teak wood surface surrounded by durable matte-finish aluminum.

## Finishes

COM/Customization: available upon request



Putty



Charcoal



Olive



Rust

## Materials & Specifications

- Stainless steel hardware
- Aluminum construction
- Solid sustainable teak top. Kiln-dried for durability
- Adjustable feet for leveling on uneven surfaces
- California Residents see [Prop 65 Warning](#)

## Other

[Care and maintenance information](#)

[Limited warranty](#)

## Dimensions

Width: 34.5"  
Depth: 34.5"  
Height: 11.8"  
Weight: 20.5 lbs

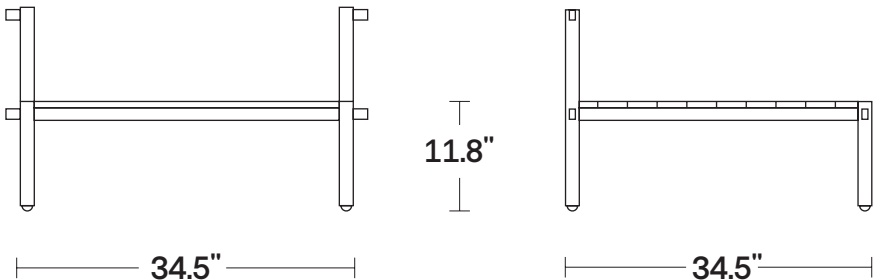

# Terra Collection

neighbor

## Modules & accessories



Left Arm



Armless



Corner



Right



Ottoman



Half In-line Table\*



In-line Table\*



Coffee Table



Side Table



Sun Lounger

\*Tables can be oriented in between seating modules and on terminals

## Popular sectional configurations

### 4-Piece

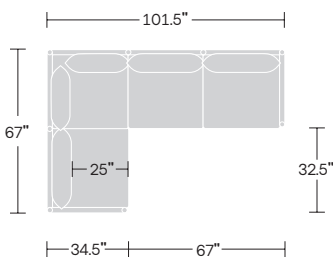

### 5-Piece

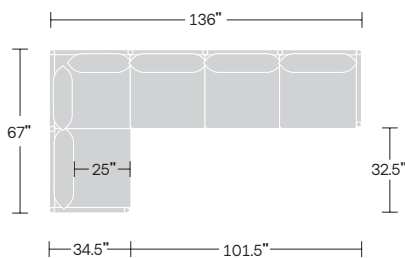

### 5-Piece Symmetrical

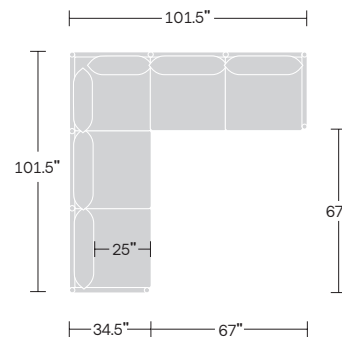

### 6-Piece

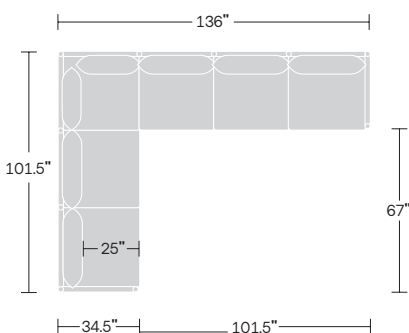

### 6-Piece U-Shaped

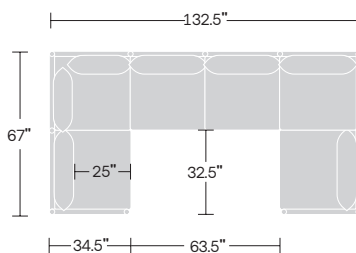

### 8-Piece U-Shaped

