

Terra In-line Half Table

neighbor



Description

Part of the Terra lounge collection, the In-line Table module can be added anywhere in your outdoor setup. Features the beauty and warmth of a teak wood surface surrounded by durable matte-finish aluminum.

Finishes

COM/Customization: available upon request



Putty



Charcoal



Olive



Rust

Materials & Specifications

- Stainless steel hardware
- Aluminum construction
- Solid sustainable teak top. Kiln-dried for durability
- Adjustable feet for leveling on uneven surfaces
- California Residents see [Prop 65 Warning](#)

Other

[Care and maintenance information](#)

[Limited warranty](#)

Dimensions

Width: 14"
Depth: 34.5"
Height: 11.8"
Weight: 14.5 lbs

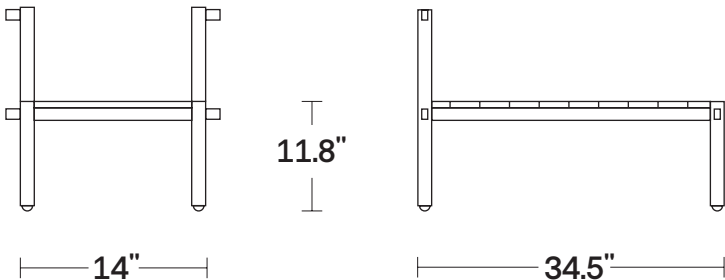

Terra Collection

neighbor

Modules & accessories



Left Arm



Armless



Corner



Right



Ottoman



Half In-line Table*



In-line Table*



Coffee Table



Side Table



Sun Lounger

*Tables can be oriented in between seating modules and on terminals

Popular sectional configurations

4-Piece

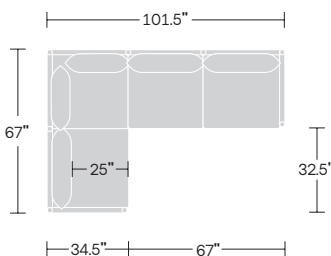

5-Piece

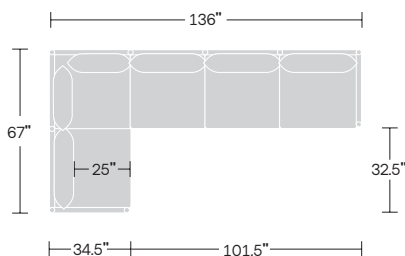

5-Piece Symmetrical

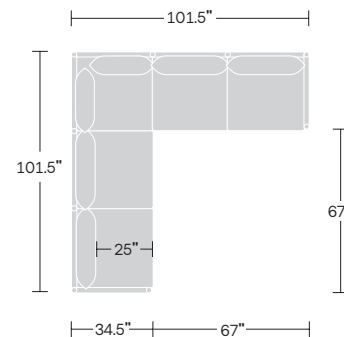

6-Piece

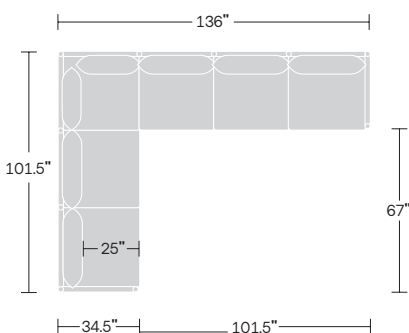

6-Piece U-Shaped

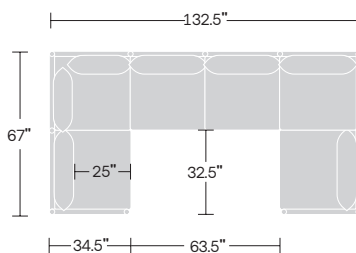

8-Piece U-Shaped

